

STANDARDIZED NODES

TURNING TABLE SOU 2000-B

The SOU 2000-B turning table is designed for transferring the machined workpiece, in a circular motion, between individual work positions, during the course of building single purpose machining equipment.

Description of basic version

The basic groups of the turning table are the basic body of the table, table board, gear box, positioning index, firming cylinders, parting device.

Basic part of the table consists of a cast iron body on which the cast iron table board rests. The table is actuated by an electric motor and hydraulic motor. The gear box and actuators are protected with a cover from splashing coolant and flying chips. The precise position of the turning part of table is set by moving index incorporated in the bottom of the table body. The table board is not lifted before turning.

The separating device serves for determining the position for slowing down and reversing the table movement. Table movements are transferred through gears to drum with rests. The rests switch end switches designed for automatic control of table turning cycle.

Four firming cylinders ensure the position of the turning part of the table against the table body during the workpiece machining.

Work position

The turning table may only operate in the horizontal position of the clamping area, the table rotates around vertical axis.

Alternative version

- table without hydraulic firming (firming is not necessary when the table serves, e.g. only for the transfer of workpieces and no machining is performed on it)
- hydraulic index control (enables performing more complex table cycles, e.g. omit certain position while turning)

Technical parameters of basic version

Table type identification	SOU 2000 B
Diameter of table board [mm]	2000
Table height [mm]	400
Number of positions	4, alt. other
Direction of turning	left, alt. right
Cycle part when parting n=4 [sec] ¹⁾	approx. 10 (approx. 7 when a frequency converter is used for electric motor control)
Electric motor output [kW]	3
Hydraulic oil consumption [dm ³ . min ⁻¹]	3
Rated pressure of hydraulic oil [MPa]	4
Table weight [kg]	5000

1) Real time depends on the torque of inertia of added mass positioned on the table.

- *The detailed data is not binding with respect to ongoing development; the basic version can be adapted according to customer requirements.*

Permitted load

Load by added mass positioned centrally [kg]	8000
Vertical central load [kN]	100
Radial load 350 mm above table [kN] ¹⁾	180
Radial load askew from bottom 350 mm above table at angle 30° [kN] ¹⁾	80
Tangential load at diameter 2,000 mm [kN] ¹⁾	35

1) Values apply for hydraulic firmed table

Basic connection dimensions

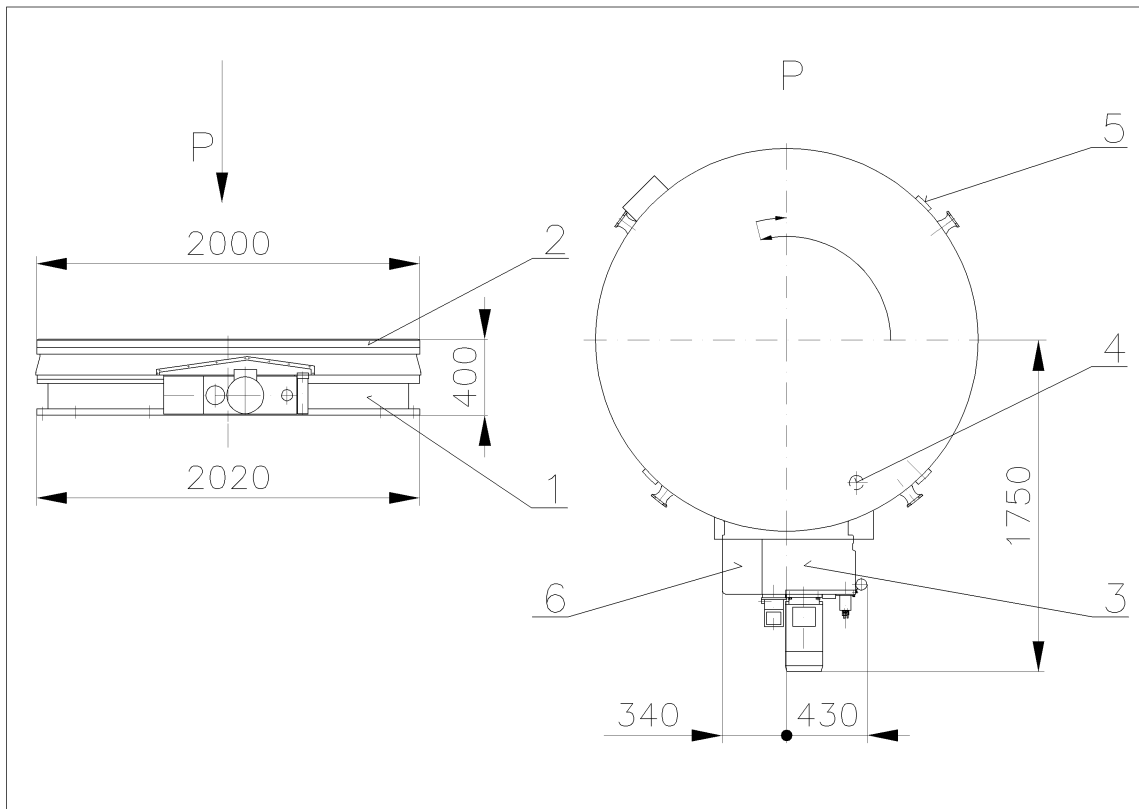

1...basic table body
2...table board
3...gear box

4...positioning index
5...firming cylinders
6...parting device

- *The detailed data is not binding with respect to ongoing development; the basic version can be adapted according to customer requirements.*